

# USER MANUAL

## PGLE SERIES PLANT GROW LIGHT Removable/Replaceable/Foldable

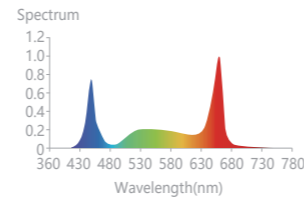
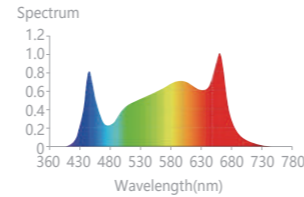

### TECHNICAL SPECIFICATIONS

Product Code	PGLE
Power	680W/720W/800W/Customized
Input Voltage	AC100-277V/AC249-528V
Input Current	2.8A@277VAC
PF	>0.95
Dimming (Optional)	0-10V/PWM
PPF	2040/2160/2400μmol/s
LED PPE	3.0 μmol/s/W (μmol/J)
Light angle	120 degree
Height	10-30 inch
Operation Temp & Humidity	-20~45 C , 20~95%RH No condensation
Storage Temp & Humidity	-20~85 C , 10~95%RH No condensation
Product L* W * H (mm)	1127*1120*57 (44.4*44.1*2.3 inch )
Carton L* W * H (mm)	1144*249*183 (45*9.81*7.21inch)
NW (kg) ±0.1	12.1
GW (kg) ±0.1	13



### 1. Usage Scenario



<b>Germination</b>  Above Canopy: 48" Dimming: 40%-50%	<b>Seedling</b>  Above Canopy: 24"-30" Dimming: 50%-80%	<b>Flowering</b>  Above Canopy: 18"-24" Dimming: 80%-100%	<b>Fruit</b>  Above Canopy: 6"-18" Dimming: 100%
---	--	--	---

- Rate of photosynthesis and transpiration are directly affected by temperature, humidity and air flow.
- The perfect temperature and humidity for your plants are found between 75-85 °F and 50%-70% humidity, with plenty of airflow to replenish CO2. PH is 6-6.5. You may add more calcium and magnesium than normally needed.

Assembly Instructions: The product includes a controller, power supply, light frame and lanyard. Please refer to the following for specific installation.

### 2. Master Controller III Instruction

For large-scale planting, our product can be compatible with a variety of controllers. Dimming connect port is reserved on the product, convenient for you to adapt different controller.

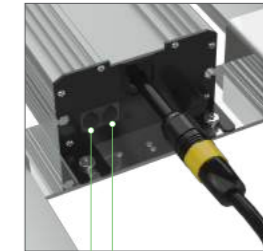

Control cable RJ11 port 1  
Control cable RJ11 port 1

Driver dimming and PWM TO RS485 dimming are optional



Master controller (support 1 channel 485 control signal)

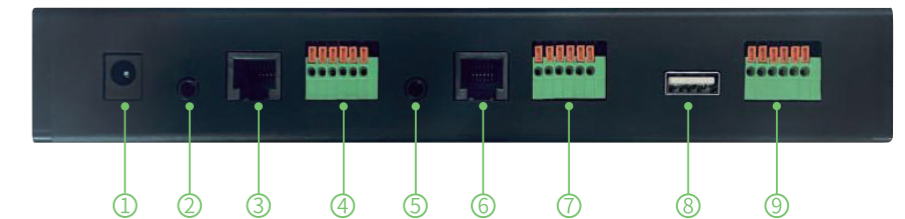

- ①: DC 5V Power Input
- ②⑤: Temperature and humidity sensor Port
- ③⑥: EXT(RJ14 Port)
- ④⑦: Relay Switch Port(Port 2-4 for Group A,5-7 for Group B)
- ⑧: USB
- ⑨:RS485 Up /RS485 Down Output

Please refer to the controller manual for details of the operating system.

### 3. Installation Steps

#### Step 1

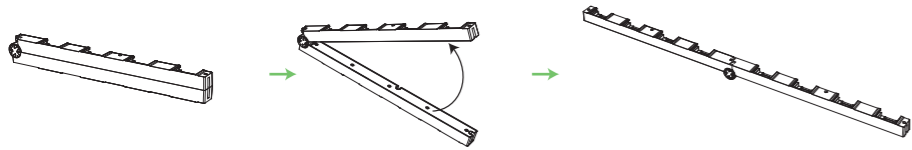

This product is designed with a folding scheme, just open the connecting rod to start the first step of installation.

#### Step 2

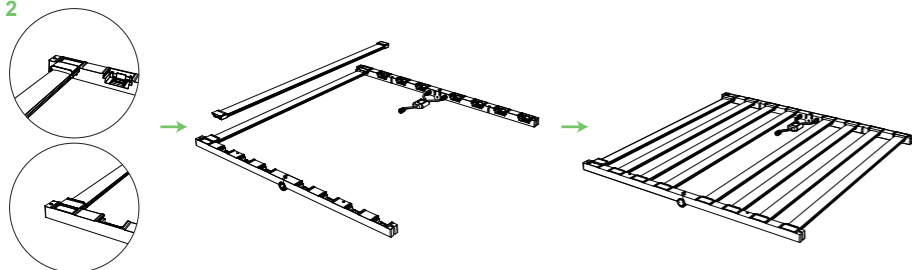

There are movable connection blocks on the light rod of the product. Gently push the light bar to be fixed onto the connecting rod. (Please note to the left and right direction of the matching socket when installing. Do not install it reverse.)

#### Step 3

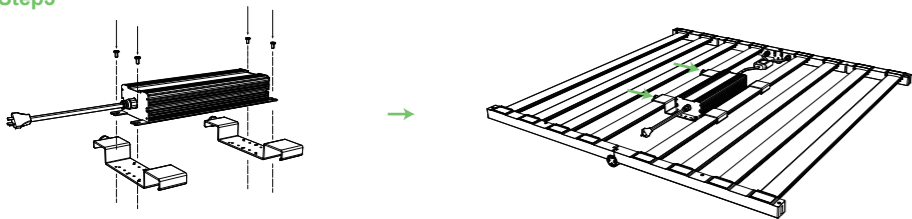

The power supply is installed on the lamp pole with a fixed bracket at the base to fasten it to the two lamp poles.

#### Step 4

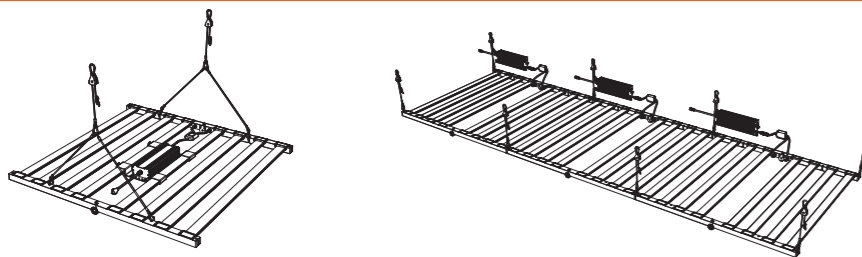

A single connection

Group connection

▲ It is recommended to remove the driver from the lamp when the hanging rope is located at the splicing hole.

The hanging holes on the product are rich, and equipped with the corresponding hanging rope. It can satisfy other hanging methods, please choose the accessories with matching aperture for operation. The maximum diameter of hanging hole is 7mm, the depth is 7.5mm.

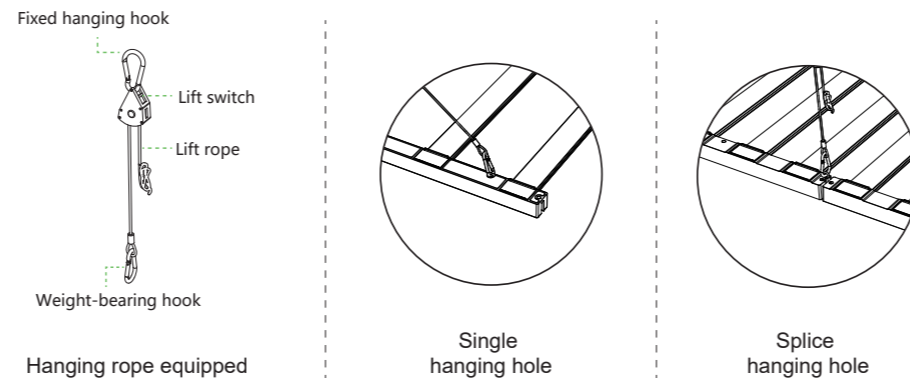

### 4. Warranty Terms

- The light can be returned or replaced within 30 days after delivery, in the precondition of non-artificial damage.
- 90 days ALL FREE warranty. Free components, repairing and service can be provided within 3 months after delivery.
- 5 years of free components can be provided.
- 3 Months -1 Year: Free Components, buyers only have to pay one-way freight and repairing fees.
- 1 Year -5 Years : Free Components, buyers bear the freight back and forth and repairing fees.

### 5. Safety Notes

Please read the manual thoroughly before attempting to install or operate LED Grow Light and keep it for future reference.

Connect the light only to the power sources of the appropriate voltage using the plug received. Protect power cables from being pinched or damaged, especially where the power cable enters the power outlet and the unit.

If the provided plug does not fit your socket, please contact us for help by email immediately. Please do not replace the power cord or plug by yourself, otherwise we are not responsible for man-made damages.

The system should only be cleaned as directed in the manual. You should seek service by qualified service personnel if any of the following occur

- 1.The power-supply cord or the plug has been damaged;
- 2.The unit has been exposed to rain;
- 3.The unit exhibits a marked change in performance;
- 4.The unit has been dropped, or its enclosure or chassis is damaged.

### 6. General Care

- LED Grow lights are passively cooled with zero moving components. They are designed for harsh environments and years of maintenance-free performance. Some basic care will keep your lights working at peak performance cycle-after-cycle.
- Natural convection removes heat away from the heat sink. In order to properly cool itself, at least one inch of space is required between the fixture and the roof of your grow area. Failure to do so may shorten the fixture's lifespan.
- To achieve the optimal lifespan and performance of your fixtures, routinely check for and remove excess dust, debris, and mineral build up from heat sink and LED array. Cleaning should always be done with the fixture or using low-pressure compressed air with unplugged from its power source.
- Never use a cloth to clean the diode array, otherwise it may scratch the integrity of the silicon seal, or dislodge diodes entirely.
- To limit degradation, avoid touching the diodes with your hands, even in a powered off state.

### 7. Caution

- In summer or other hot environment, please use a cooling fan to keep a suitable temperature for your plants.

### 8. Warning

- Do NOT touch while in operation.
- To prevent eye damage, avoid looking directly at the LEDs.
- To reduce the risk of overheating or fire, always allow for adequate ventilation of fixtures and power supplies.



- Read through this manual before installation.
- Handle the product with care.
- The product must be grounded.
- This product must be installed and maintained by certified electrician.
- Consult with the manufacturer before maintenance.
- Turn OFF the power before installation and maintenance.
- Make sure the products are securely installed.
- The housing might become hot after operation.
- Primary use: auxiliary lamp used to promote plant growth and maturity.
- Make sure the construction is strong enough to support the products.
- The product will automatically turn to 50% brightness once the temperature goes too high(temperature on driver box >85°) ; and will automatically turn on once it cools down(<45°) .
- The external flexible cable or cord of this luminaire cannot be replaced; if the cord is damaged, the luminaire shall be destroyed.

