

# HIGHBAY-7 200W(adjust by switch 150W/100W)

Intelligent group networking/Microwave radar sensors/Adjustable beam angle lens/Modular design



# HIGHBAY-7 Adjustable beam angle high bay

## Product presentation

HIGHBAY-7 is a type high bay light in adjustable beam angle that meets wireless control and gather the product data by networking. The widely used applications in manufacturing, warehouse, logistics center, exhibition hall and other scenes.

## Product features

- Wattage: 200W (adjust by switch 150W/100W);
- Color temperature : Adjusted in three gears
- luminous efficiency: 150lm/W, 170lm/W
- Optics beam angle: Multi-speed adjustable,60°/90°
- Protection: IP65, IK08;
- Using environment: The lamps using ambient temperature -25 ~ +45°C,lifespan 50000H ;
- Power protection: The power supply has short circuit protection (SCP)/Over-voltage protection (OVP)/Over-temperature protection (OTP);
- dimming control : 0-10V, Dali 2(D4I);
- Controller interface: Zhga book18 Standard interface ;
- Installation(suspending/derrick/bracket) to meet different customers' demands.

单位: mm

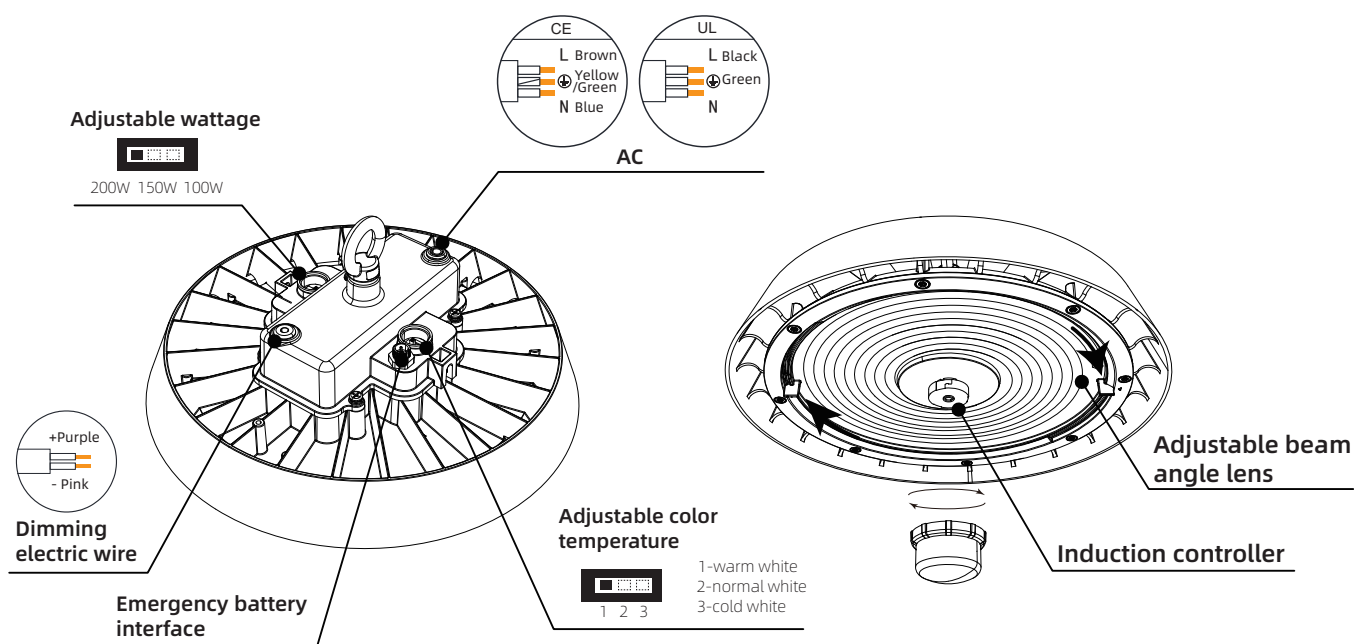
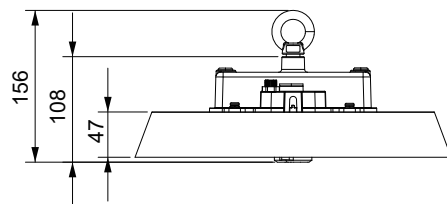
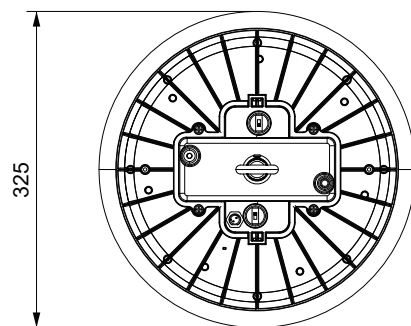

# HIGHBAY-7 Adjustable beam angle high bay

## Intelligent control

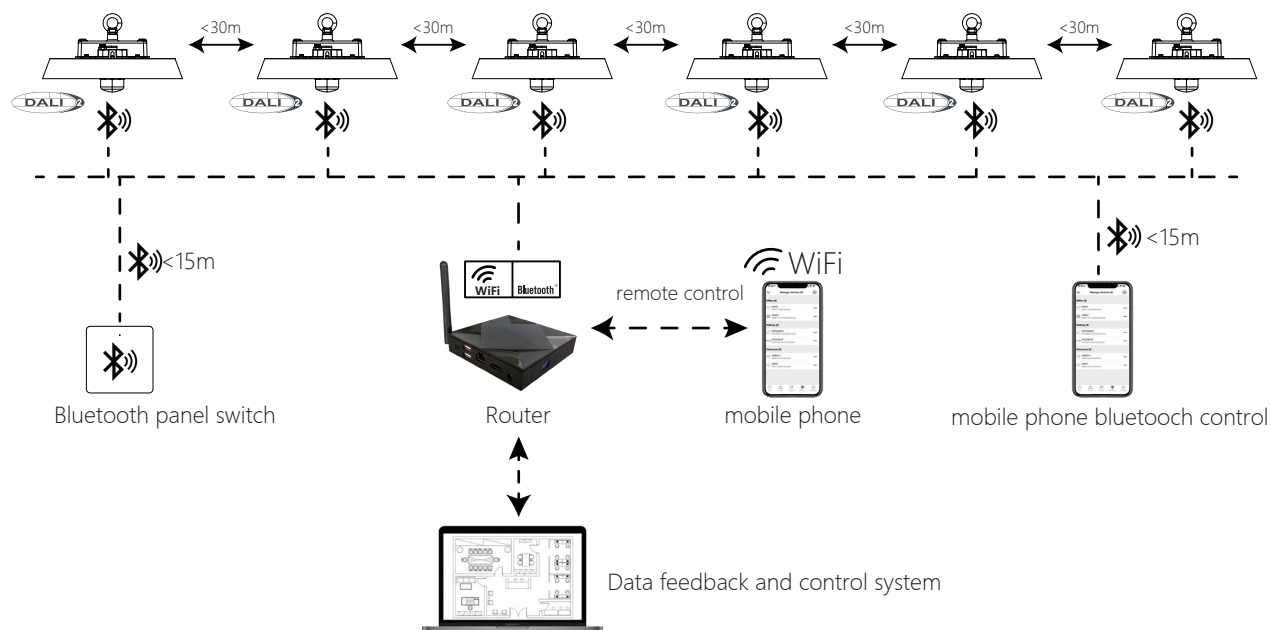

## Specification parameter

Model name	HIGHBAY-7		
Wattage	100W (Dimming)	150W (Dimming)	200W (Dimming)
Input voltage	AC200-240V 47-63Hz		
Power factor	>0.9		
Surge protection	L/N-G>4KV & L-N>4KV		
THD (total harmonic distortion)	<10%		
LED chips	SMD2835		
CCT	Multi-speed adjustable		
CRI(color rendering index)	>70 or >80		
Beam angle	60°/90°		
luminous efficiency	150lm/w 170lm/w		
IP grade	IP65		
IK grade	IK08		
Guarantee	5 Years		
life span	50000 Hours		
Operating temperature	-20°C ~ +45°C		
Housing materials	Die-cast Aluminum + PC LENS		
Housing color	Black		
Product dimension	325X325X108mm		
Net weight	2.75kg		
Outer box packing size	390X390X146mm		
Gross weight	3.6kg		
Installation	suspending/derrick/bracket installation		

# HIGHBAY-7 Adjustable beam angle high bay

## Photometric data

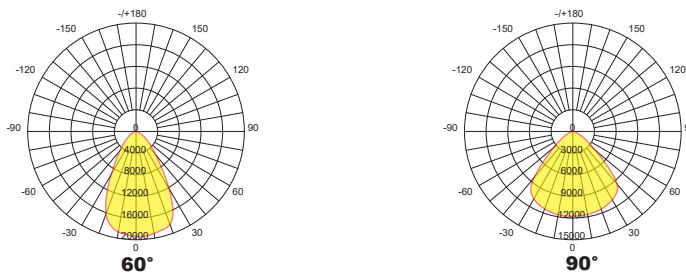

## Warm tips

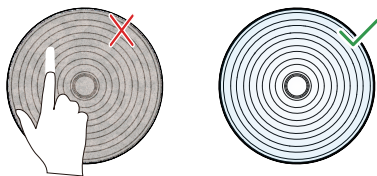

Basing on the influence of real application environment, and considering the safety factors of long-term operation of the equipment, should make the inspection and maintenance plan, and the surface of the lens product should be regularly cleaned and maintained.

Secondary fall protection is recommended for all suspension mounting luminaires/equipment.

## Container loading reference

Unit: mm

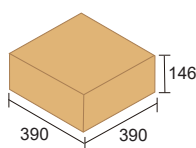

QTY of containers installed		Unit PCS		
GHBL-Ex	Container	20GP	40GP	40HQ
	Product Qty	1440	2880	3240

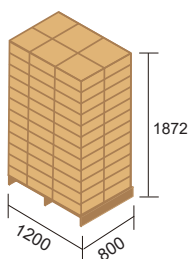

QTY of containers installed		Unit PCS		
GHBL-Ex	Pallets(1200×800×120mm)	Container	20GP	40GP
	Product Qty: 72/PCS	Pallets Qty	11pcs	24pcs
		Product Qty	792pcs	1728pcs