

# KHBL LED high bays

200W(Adjust by swith 150W/100W)

Intelligent networking/Microwave radar sensing/modular design



## Product presentation

KHBL is a type high bay light that meet wireless control and gather the product data by networking. The widely used applications in manufacturing, warehouse, logistics center, exhibition hall and other scenes.

## Product features

- Wattage: 200w(adjust by switch150W/100w)
- Color temperature: Adjusted in three gears
- luminous efficiency: 150lm/W,170lm/W
- Optics beam angle: 60°/90°/120
- Protection: IP65, IK08
- The lamps using ambient temperature: The lamps using ambient temperature -25 ~ +45°C, lifespan 50000H
- Power protection: The power supply has short circuit protection(SCP), Over-voltage protection(OVP), Over-temperature protection(OTP)
- dimming control: 0-10V, Dali 2(D4i)
- Controller interface: Zhaga book18 Standard interface
- Installation(suspending/derrick/bracket) to meet different customers' demands

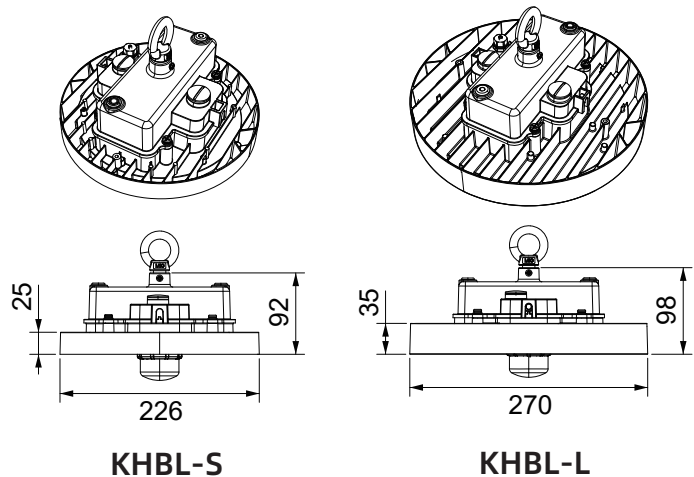

unit: mm

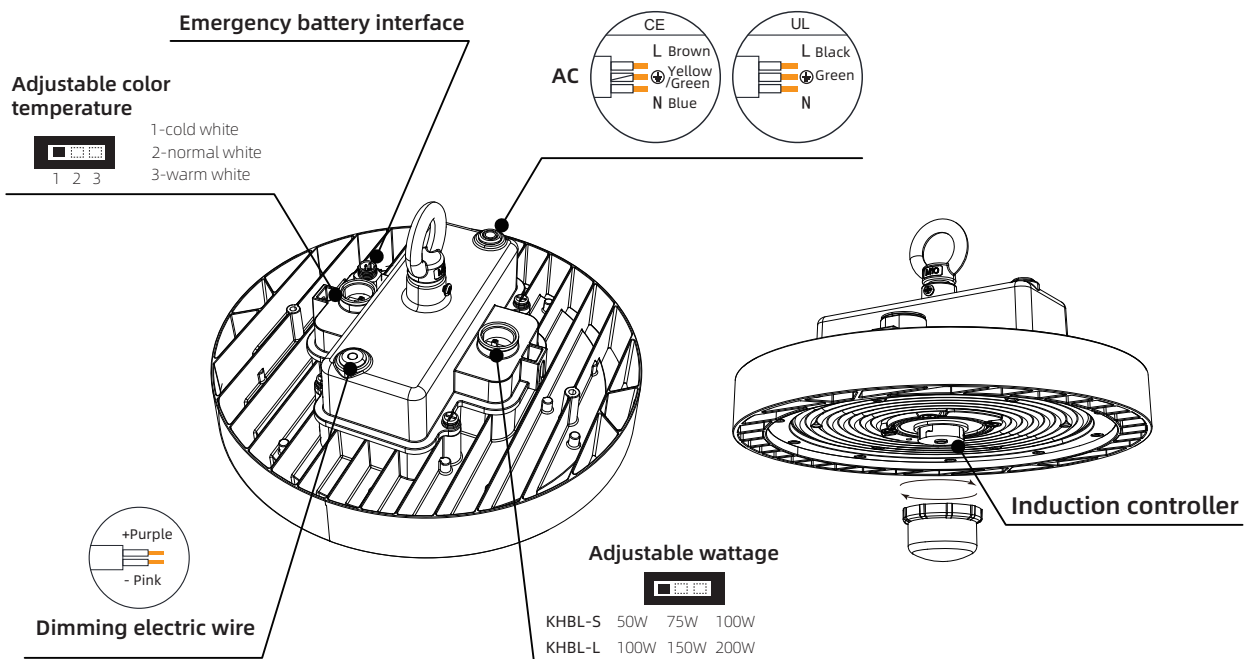

## Intelligent control

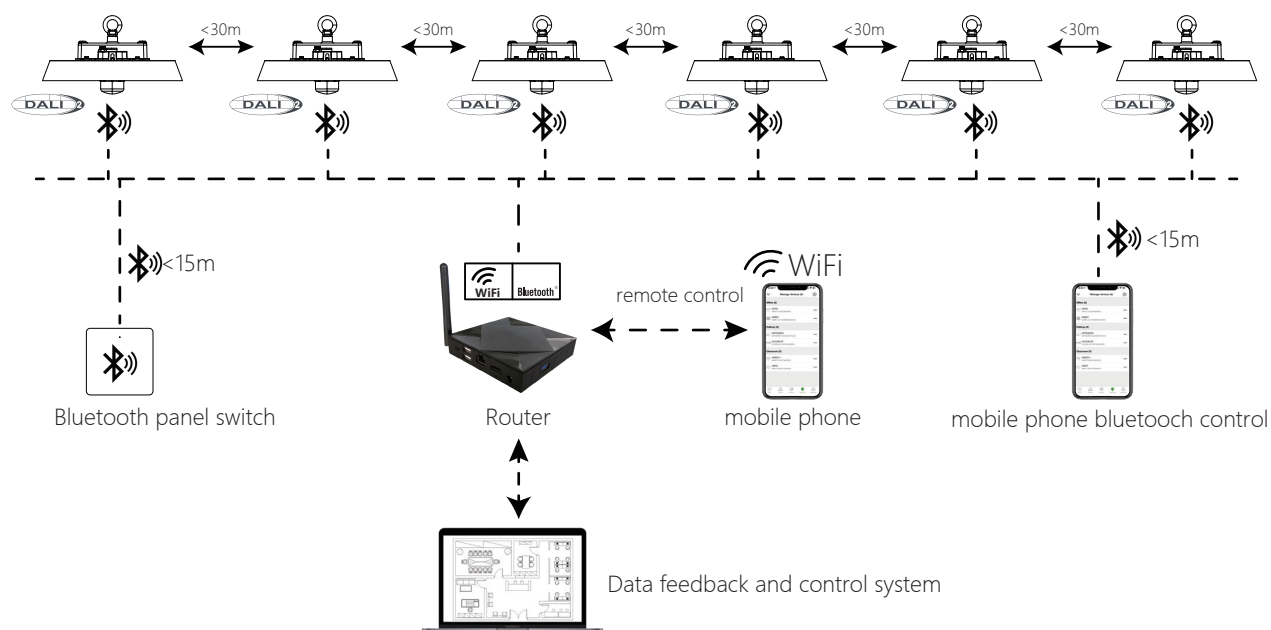

## Specification parameter

Model name	KHBL- S	KHBL- L
Wattage	50W/75W/100W (Dimming)	100W/150W/200W (Dimming)
Input voltage	AC200-240V 47-63Hz	
Power factor	>0.9	
Surge protection	L/N-G>4KV & L-N>4KV	
THD (total harmonic distortion)	<10%	
LED chips	SMD2835	
CCT	Multi-speed adjustable	
CRI(color rendering index)	>70 or >80	
Beam angle	60/90/120°	
luminous efficiency	150lm/w 170lm/w	
IP grade	IP65	
IK grade	IK08	
Guarantee	5 Years	
life span	50000 Hours	
Operating temperature	-20°C ~ +45°C	
Housing materials	Die-cast Aluminum + PC LENS	
Housing color	Black	
Product dimension	266X266X92 mm	270X270X98 mm
Net weight	1.65 KG	2 KG
Outer box packing size	302X302X155 mm	345X345X155 mm
Gross weight	2.5 KG	2.6 KG
Installation	suspending/derrick/bracket installation	

## Photometric data

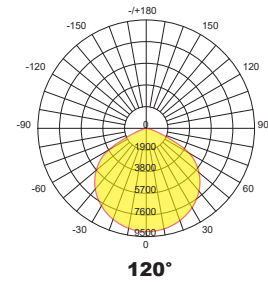
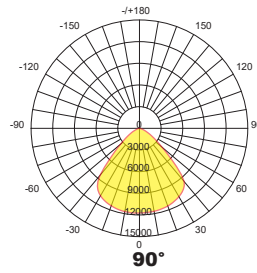
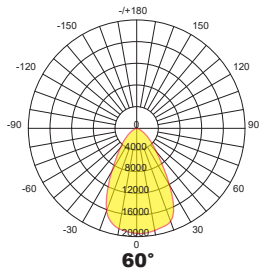

## Warm tips

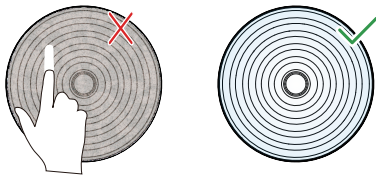

Basing on the influence of real application environment, and considering the safety factors of long-term operation of the equipment, should make the inspection and maintenance plan, and the surface of the lens product should be regularly cleaned and maintained.

Secondary fall protection is recommended for all suspension mounting luminaires/equipment.

## Container loading reference

Unit: mm

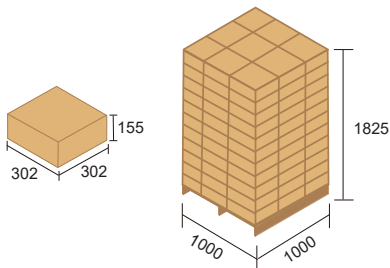

QTY of containers installed		Unit PCS		
KHBL-S	Container	20GP	40GP	40HQ
	Product Qty	1995 pcs	4095 pcs	4641 pcs

QTY of containers installed		Unit PCS		
KHBL-S	Pallets(1000×1000×120mm)	Container	20GP	40GP
	Product Qty: 99/PCS	Pallets Qty	10 pcs	22 pcs
		Product Qty	990 pcs	2178 pcs

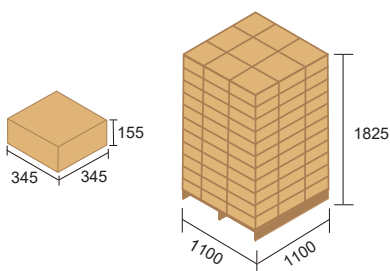

QTY of containers installed		Unit PCS		
KHBL-L	Container	20GP	40GP	40HQ
	Product Qty	1530 pcs	3060 pcs	3468 pcs

QTY of containers installed		Unit PCS		
KHBL-L	Pallets(1100×1100×120mm)	Container	20GP	40GP
	Product Qty: 99/PCS	Pallets Qty	10 pcs	20 pcs
		Product Qty	990 pcs	1980 pcs